

## 1. Introduction

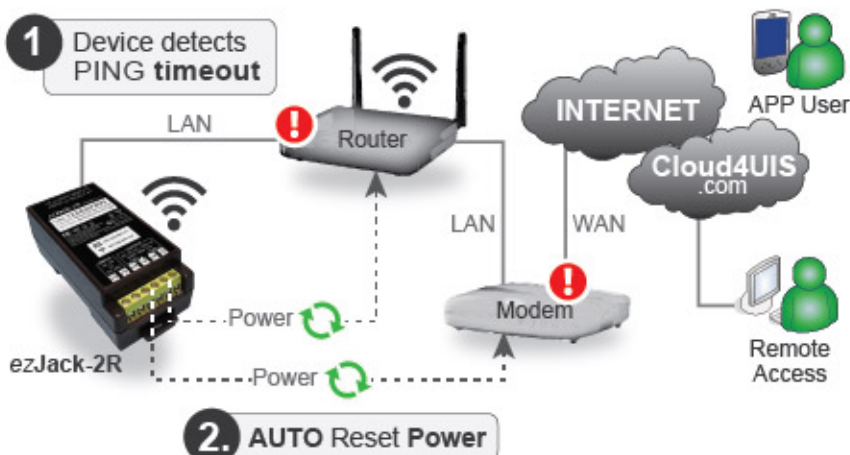

### Summary Features:

- Auto Reset DC Power to when ping failure is detected.  
eg.: Reset unresponsive Wi-Fi AP, Router, IP cam, NAS or network device.
- Remotely turn output On / Off / Reset  
Managed thru ezDevice APP or Cloud4UIS.com.
- Set scheduled output On / Off / Reset  
eg.: Schedule IP Cam, Wi-Fi AP, Router, etc to reset.

## 2. Description

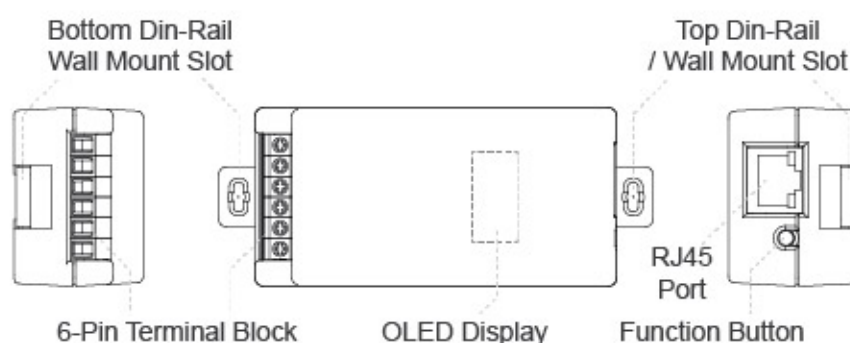

## 3. Specifications & Certifications

Connector Type	Terminal Block. 1x DC-In, 2x DC-Out Channels
DIN Rail Specification	TS-35/7.5/1.0, TS-35/15/1.5 DNR274, DNR314, DNR315
Electrical Rating	Input = DC 9V ~ 48V, 2A Output = DC 9V ~ 48V, 2A (CH1 + CH2) MAX 96W
Wireless LAN	Wi-Fi 2.4GHz (802.11b/g), Bluetooth BLE 4.2 Ethernet 10/100 Base-T
Certification	FCC ID: 2AC7Z-ESP32WROOM32E IC ID: 21098-ESPWROOM32E CMIIT ID: 2020DP2713 CE CCA21Y1002T0 R-C-es5-ESP32WROOM32E
Operating Condition	0°C ~ 70°C at 10% ~ 90% relative humidity. For Indoor Use Only!

## 4. Setup and Add Device to Cloud4UIS

**Step 1:** Connect power to DC input terminals and LAN from router.

**Step 2:** Install ezDevice APP, and [Sign Up] for a Cloud4UIS Account.



**Step 3:** Scan QR code or Select Model to Add Device to Cloud4UIS.

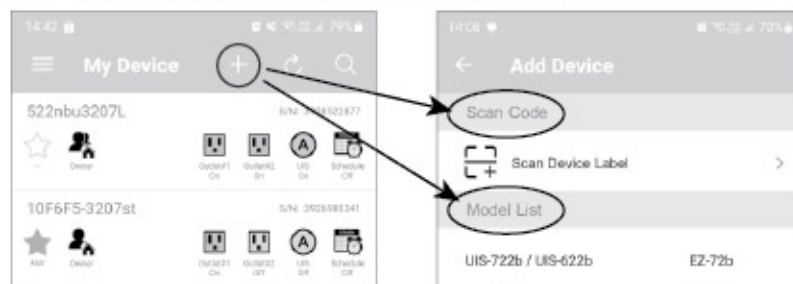

### NOTE:

- OLED will show **Cloud Linked** when Add is successful.
- The first person to 'Add' the device becomes the 'Owner'.
- 'Owner' can 'Share' device with Cloud4UIS users and set permission.

### TIPS:

Configure channels to [Reset Only] to avoid accidental remote power Off.

## 5. Access Device Web User Interface (GUI)

Access ezJack-2R built-in Web User Interface by entering it's LAN IP address into any browser.

**http://<IP-address-of-Device>** eg.: **http://192.168.0.123**

### NOTE:

See Cloud4UIS or APP for device LAN IP address or check router DHCP table.

## 6. Enable Auto Reset when Ping Fails

1. Connect Router's power to ezJack-2R output channel. Allow router to initiate and connect to internet.
2. Once ezJack-2R connects to internet (see OLED). Press and hold **Function Button** to enter **OLED Menu**.
3. Highlight **Auto Reset**. Press and Hold to set to **ON**.
4. ezJack-2R channels will **Auto Power Reset** when ping fails.

## 7. Remove Device from APP and Cloud4UIS

**Method 1:** From either APP or Cloud4UIS Account.  
Select **[Remove Device]**.

**NOTE:** This action removes device from APP or Cloud. The individual configuration is still retained on device.

**Method 2:** From Device: Reset to Factory Default.  
Press & Hold Outlet #1 & #2 for 10 seconds. Release when all three LED start blinking.

**NOTE:** This action clears device configuration and removes device link to APP / Cloud4UIS Account.



Scan QR Code for Guide

rev. 4523

